

12" TO 66" DIAMETER

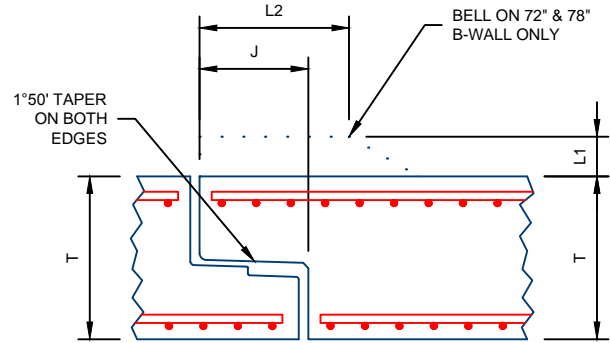

72" TO 120" DIAMETER

D: INTERNAL DIAMETER OF PIPE IN IN.	CROSS SECTIONAL WATER AREA (SQ. FT)	WEIGHT PER LINEAR FOOT OF PIPE (LBS)	T: MINIMUM WALL THICKNESS	J: LENGTH OF JOINT	L1: B WALL	L1: C WALL	L2: MINIMUM
12	0.79	153	3"	3 ³ / ₈ "	2"	0	5"
15	1.23	191	3"	3 ⁵ / ₈ "	2 ³ / ₁₆ "	0	4 ³ / ₄ "
18	1.77	185	2 ¹ / ₂ "	3 ⁵ / ₈ "	2 ³ / ₈ "	0	5"
21	2.40	238	2 ³ / ₄ "	3 ³ / ₄ "	2 ¹ / ₈ "	0	5 ¹ / ₄ "
24	3.14	295	3"	3 ⁷ / ₈ "	2 ¹ / ₄ "	2"	5 ¹ / ₂ "
27	3.98	362	3 ¹ / ₄ "	4"	2 ¹ / ₄ "	2"	5 ¹ / ₂ "
30	4.91	480	4 ¹ / ₄ "	4"	2 ³ / ₄ "	2"	5 ¹ / ₂ "
33	5.94	600	4 ¹ / ₂ "	4 ¹ / ₈ "	2 ⁷ / ₈ "	2 ¹ / ₈ "	6"
36	7.07	680	4 ³ / ₄ "	4 ¹ / ₂ "	3 ³ / ₈ "	2 ³ / ₈ "	7"
42	9.62	870	5 ¹ / ₄ "	4 ⁵ / ₈ "	3 ³ / ₄ "	3"	7 ¹ / ₂ "
48	12.57	1100	5 ³ / ₄ "	4 ³ / ₄ "	4 ¹ / ₈ "	3 ³ / ₈ "	7 ¹ / ₂ "
54	15.90	1315	6 ¹ / ₄ "	5"	3 ³ / ₈ "	2 ⁵ / ₈ "	7 ¹ / ₂ "
60	19.63	1525	6 ³ / ₄ "	5"	3 ¹ / ₈ "	2 ³ / ₈ "	7 ¹ / ₂ "
66	23.76	1820	7 ¹ / ₄ "	5"	2 ³ / ₄ "	2"	7 ¹ / ₂ "
72	28.27	2040	7 ³ / ₄ "	5 ¹ / ₄ "	3 ¹ / ₄ "	0	7 ¹ / ₂ "
78	33.18	2100	8 ¹ / ₄ "	5"	3 ¹ / ₄ "	1 ¹ / ₁₆ "	8"
84	38.48	2410	8 ³ / ₄ "	5"	0	0	0
96	50.27	3380	9.75"	5"	0	0	0
108	63.62	3870	10"	5"	0	0	0
120	78.54	4720	11"	6"	0	0	0

NOTES:

- ALL PIPE IS MANUFACTURED IN ACCORDANCE WITH ASTM C-76 & C-361

For more information about our products please contact us at:
(320) 392-5207

www.hancockconcrete.com

© 2015 Hancock Concrete Products, LLC